

N/T
CITY OF RYE
BLIND BROOK

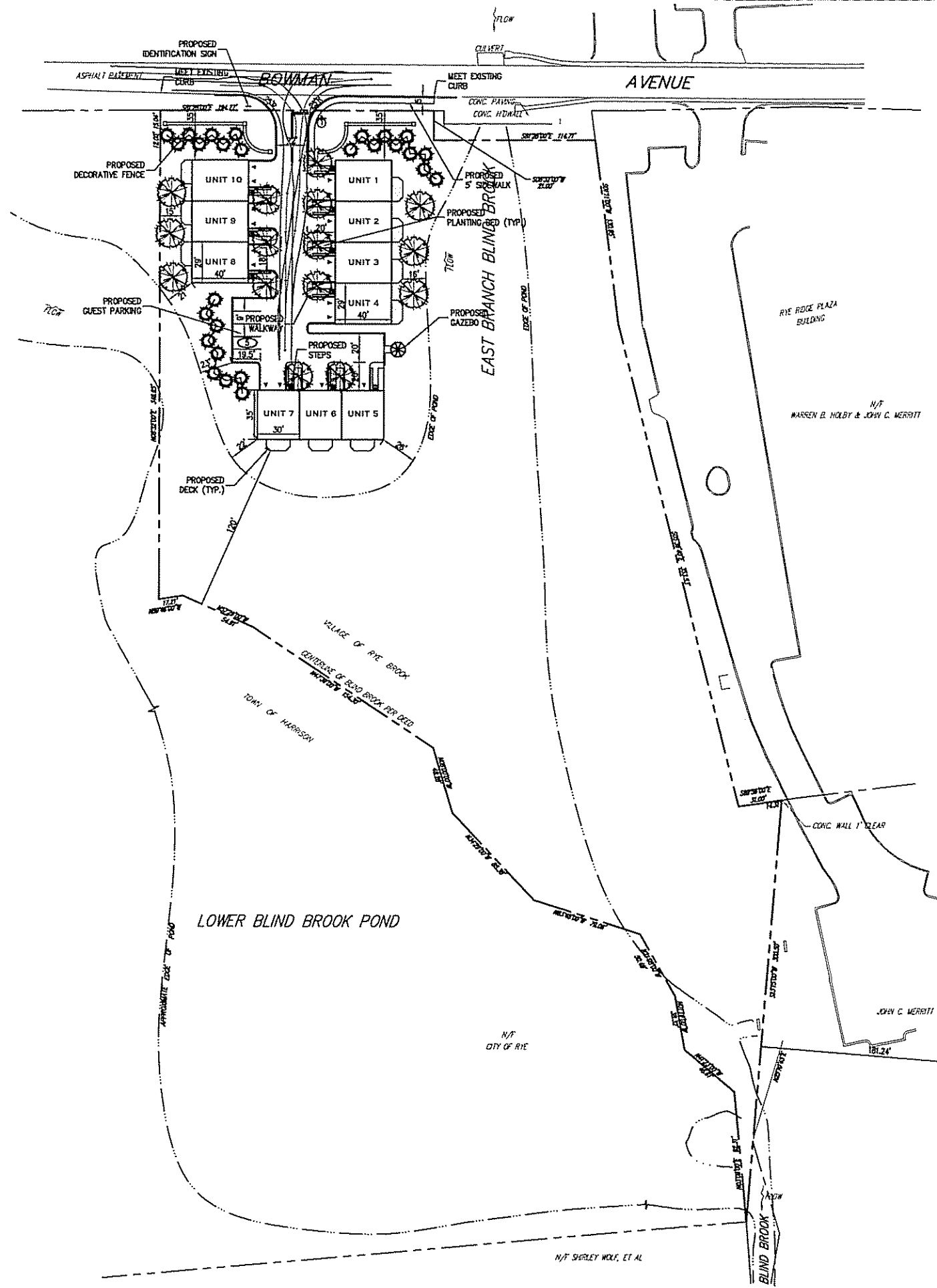

FIRE TRUCK LEGEND

- PROPOSED BUILDING LINE
- CHANNEL LINE
- CONCRETE CURB
- EASEMENT
- EDGE OF WATER
- OVERHEAD WIRES
- PROPERTY LINE
- PROPOSED SIDEWALK
- PROPOSED RETAINING WALL
- TRAFFIC SIGN LOCATION & DESIGNATION
- 18" WIDE STOP LINE
- 2-4" WIDE YELLOW LINES (8" O.C.)
- STANDARD PARKING
- VISITOR PARKING
- PROPOSED TIRE CLEARANCE PATH
- PROPOSED TRUCK CENTERLINE

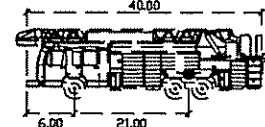

FIRE TRUCK feet

| | |
|-------------------|-------|
| Width | 6.00 |
| Track | 6.00 |
| Lock to Lock Time | 6.00 |
| Steering Angle | 40.00 |

FIRE TRUCK PROFILE

K & M REALTY GROUP, LTD.
11 SYLVANUECH ROAD
PURCHASE, NEW YORK 10577

1230 Haddonfield Road
Aurham, NY 10804
Phone: 914.473.5295 • Fax: 914.473.2192
www.johnmeyerconsulting.com

JMC
JOHN MEYER CONSULTING

**FIRE ACCESS PLAN
(MITIGATION PLAN)**
BOWMAN AVE. DEVELOPMENT
BOWMAN AVENUE
VILLAGE OF RYE BROOK, NEW YORK

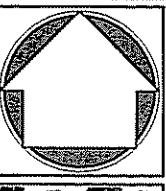

| NO. | REVISION | DATE |
|-----|----------|------|
| | | |
| | | |
| | | |
| | | |
| | | |

| | |
|--------------|-----------------|
| SCALE | N.T.S. |
| DATE | 05/21/2005 |
| PROJECT NO. | 2001142 |
| REVISION NO. | P-1 |
| FIGURE NO. | FIGURE 7 |

COPYRIGHT © 2005 By John Meyer Consulting
All Rights Reserved. No part of this document may be reproduced, stored in a retrieval system, or transmitted in any form or by any means, electronic, mechanical, photocopying, recording, or otherwise, without the prior written permission of John Meyer Consulting. Any reproduction or use of this document without the prior written permission of John Meyer Consulting shall render such reproduction and use void.