

N/F  
CITY OF RYE

LEGEND	
	PROPERTY LINE
	EXISTING EASEMENT
	EXISTING EDGE OF WATER
	EXISTING GRADE
	EXISTING SPOT GRADE
	PROPOSED FINISHED GRADE
	PROPOSED SPOT GRADE
	EXISTING MANHOLE
	EXISTING DRAINAGE INLET
	EXISTING WING WALL
	PROPOSED END WALL
	WETLAND BOUNDARY LINE
	PROPOSED DRAIN INLET
	PROPOSED MANHOLE
	PROPOSED RIP RAP APRON
	LIMITS OF UNDERGROUND DETENTION FACILITY

NOTES:

- APPROXIMATE FLOODWAY LIMIT TAKEN FROM "FLOOD BOUNDARY AND FLOODWAY MAP TOWN OF RYE, NEW YORK, WESTCHESTER COUNTY" DATED SEPTEMBER 28, 1979.
- WETLANDS WERE DELINEATED BY EVANS ASSOCIATES PER ARMY CORPS OF ENGINEER STANDARDS. ORANGE PLASTIC FLAGGING MARKED "WETLAND BOUNDARY" NUMBERED 1 THROUGH 12 AND 15 THROUGH 27 WERE LOCATED BY FIELD SURVEY ON DECEMBER 20, 1994.

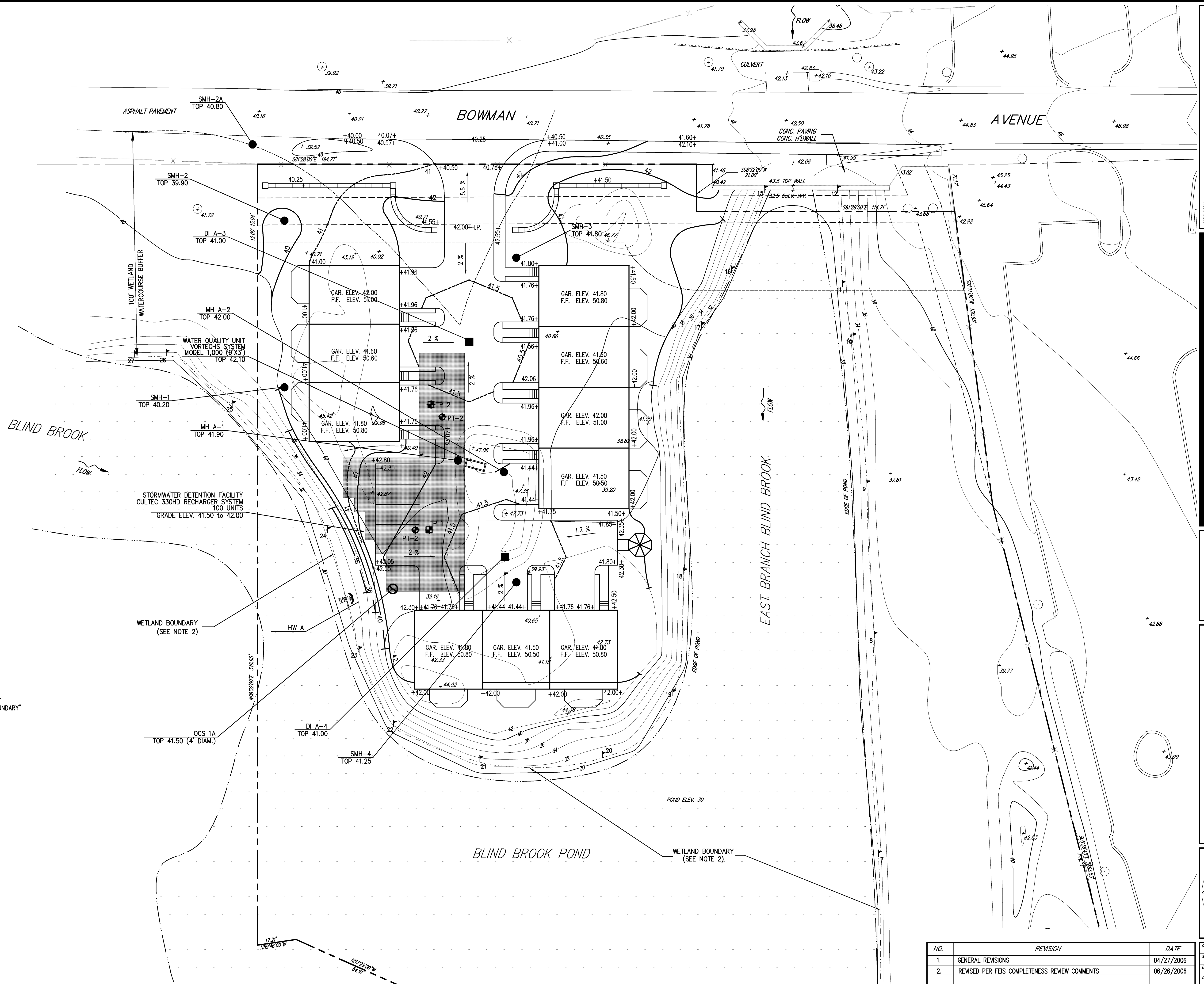

K & M REALTY GROUP, LTD.  
11 SYLVANLEIGH ROAD  
PURCHASE, NEW YORK 10577

120 Bedford Road  
Armonk, NY 10504  
voice 914.273.5225 • fax 914.273.2102  
www.johnmeyerconsulting.com

**JMC**  
JOHN MEYER CONSULTING, P.C.

GRADING PLAN

BOWMAN AVE. DEVELOPMENT  
BOWMAN AVENUE  
VILLAGE OF RYE BROOK, NEW YORK

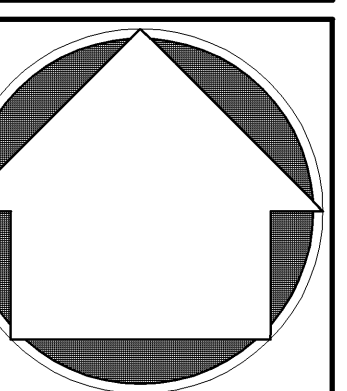

NO.	REVISION	DATE	DRAWN	MQ	APPROVED	JAR
1.	GENERAL REVISIONS	04/27/2006				
2.	REVISED PER FEIS COMPLETENESS REVIEW COMMENTS	06/26/2006				

SCALE: 1"=20'  
DATE: 04/07/2006  
PROJ. NO.: 2001142  
SITE DWG: 20 SCALE: 1/8"=1'-0" GRAD. PLOT  
DRAWING NO.: M-4

COPYRIGHT © 2006 By John Meyer Consulting  
All Rights Reserved. No part of this document may be reproduced, stored in a retrieval system, or transmitted in any form or by means, electronic, mechanical, photocopying, recording or otherwise, without the prior written permission of John Meyer Consulting. Any modifications or alterations to this document without the written permission of John Meyer Consulting shall render them invalid and unusable.

Previous Editions Obsolete